

Countertop Reverse Osmosis Water Dispenser

User Manual

Contents

Before Installation	1
Inspect the Package	1
Specifications	2
Product Introduction	2
Touch Screen (Control Panel)	2
First Use	3
Operation and Settings	4
Volume Setting	4
Temperature Setting	4
Keep Warm Setting	4
Pre-boiled Setting	4
High Altitude Setting	4
Filter Life Reminder and Replacement Guide	5
Error Display	6
Troubleshooting	6
Dispenser Maintenance	7
Limited Product Warranty	7
Safety Notice	8

Before Installation

Inspect the Package

Inspect dispenser to ensure nothing is left out or damaged during shipping. If there are any parts cracked or broken, please feel free to contact our customer service for help:

TEL: +1-888-352-3558 (U.S.)

E-mail: service@waterdropfilter.com

Specifications

To achieve the optimal performance, it is highly recommended to use the dispenser within the operational parameters.

Model	WD-M1-US
Size (L x W x H)	9.5" x 12.8" x 15.7"/240 x 325 x 400 mm
Feed Water Temperature	41-100 °F/5-38 °C
Daily Production Rate	75 GPD
Feed Water Requirement	Municipal Tap Water
Power	1050 W
System Voltage	110-120 V~
Rated Frequency	50/60 Hz
Feed Water TDS Level	TDS<500
Feed Water Tank Capacity	4.7 L/160 oz
Glass Pure Pitcher Capacity	1.5 L/50 oz

⚠ NOTE: Do not use it with water that is microbiologically unsafe of unknown quality without adequate disinfection before or after using of the dispenser.

If you are using well water as the source, please ensure that the feed water has been through a pre-filtration system.

Before Installation

Product Introduction

The brief introduction of various parts and sample connections are presented as follows. Please identify and get familiar with these parts and connection points for a smooth installation.

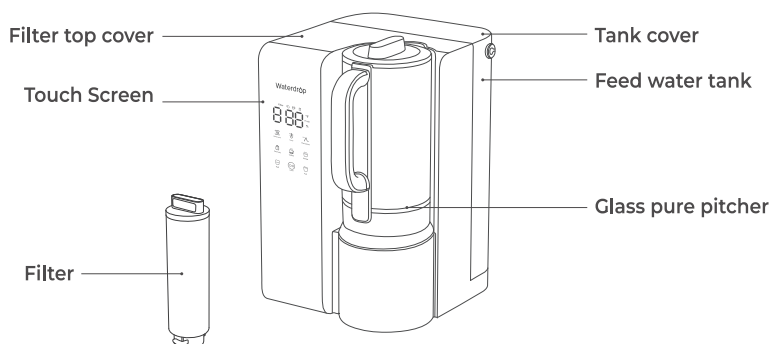

NOTE: The dispenser accessories, user interface are schematic diagrams, for reference only. Due to the update and upgrade of the product, the actual product is slightly different from the schematic diagram, please refer to the actual product.

Touch Screen (Control Panel)

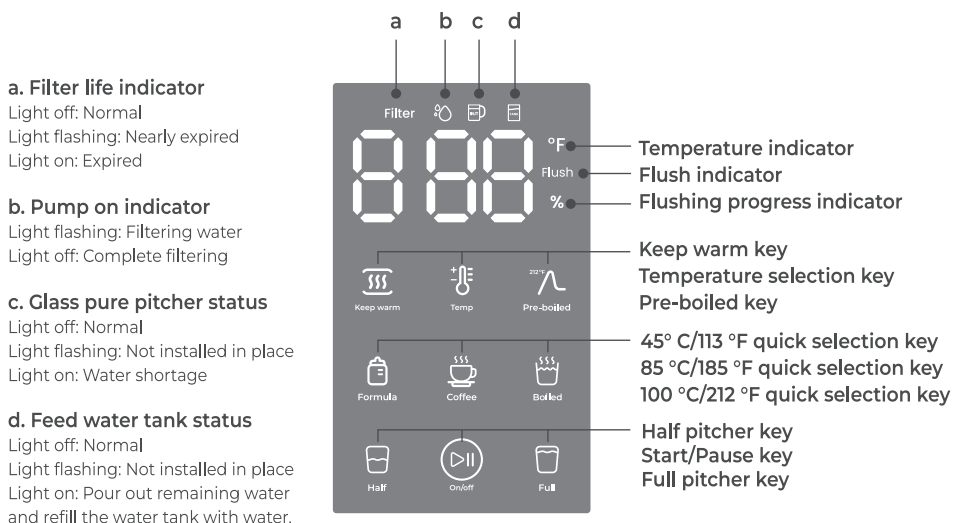

First Use

After the dispenser is first used or the filter is replaced, it needs to be flushed. Please refer to the following instructions.

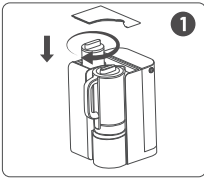

1. Remove the filter packaging of the filter element and install the new filter as directed.

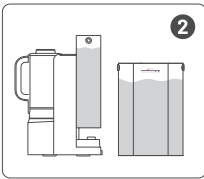

2. Fill the feed water tank.
Don't exceed the MAX water level.

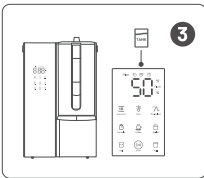

3. After the system is powered on, it will automatically flush the filter. When the feed water tank indicator “” lights on, pour out remaining water and refill the water tank.

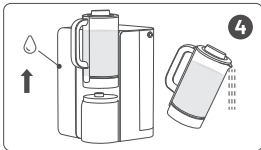

4. The system will filter water into glass pure pitcher automatically, when the “” key flashes blue, and pour water of glass pure pitcher out.

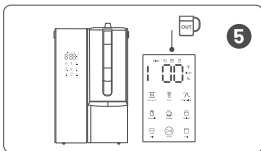

5. Repeat the above step 4 again until the flushing of the two feed water tanks is completed, or the progress shows 100%, this step takes about 20 minutes in total.

! NOTE:

When feed water tank indicator “” lights on, please lift the feed water tank, pour out remaining water and refill the water tank with water.

When using for the first time or after replacing a new filter, the foam in the feed water tank is caused by the protective liquid in the new filter, which is a normal phenomenon. Please feel free to use.

Operation and Settings

Volume Setting

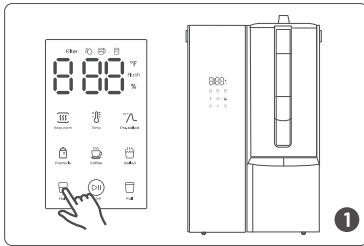

Press the any key to wake up the screen, and press the “ ” or “ ” key to select your desired water volume. (Half: extra filtered water 25 oz; Full: extra filtered water to 50 oz.)

! TIPS: If the glass pure pitcher is completely emptied, 50 oz of water will be automatically produced.

Temperature Setting

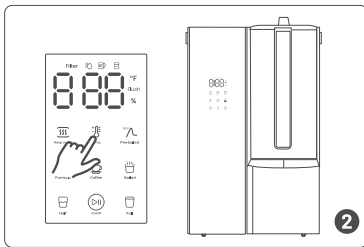

1. Press the “ ”key to select your desired temperature from the ambient to 113 °F, 131 °F, 149 °F, 167 °F, 185 °F, 203 °F, 212 °F.

! TIPS: Hold the “ ” key 3 seconds to select your desired temperature, press the key once increase the temperature by 9 °F. Press “ ” key will complete the setting.

2. When you press “ ” quick selection key, the system will heat the glass pitcher Water to 113 °F.
3. When you press “ ” quick selection key, the system will heat the glass pitcher Water to 185 °F.
4. When you press “ ” quick selection key, the system will automatically heat up to 212 °F, but it will not perform keep warm function.

Keep Warm Setting

When the temperature is selected and the “ ” key is selected simultaneously, the system will automatically heat and keep this temperature. Press “ ” key again to cancel this setting. When select the temperature for "212 °F", Keep Warm couldn't be used.

! NOTE: When you selected the temperature 194 °F, 203 °F or 212 °F, the “ ” key will not work.

Pre-boiled Setting

When the temperature is selected and the “ ” key is selected simultaneously, the system will first heat the water to 212°F for boiling. Then, it will gradually lower the temperature to the designated one and maintain it continuously. Press “ ” key again to cancel this setting.

! TIPS: The settings will be clear 48 hours later.

! NOTE: When you selected the temperature 194 °F, 203 °F or 212 °F, the “ ” key will not work.

High Altitude Setting

When the dispenser is used in the high-altitude area, please set the dispenser as follows:
Hold “ ” + “ ” keys for 3 seconds at the same time to start the high-altitude setting mode
Press the “ ” key once to increase the temperature by 9 °F at a time. Press “ ” key to confirm.

Altitude Range (m)	Temperature Setting (°F)	Maximum Heating Temperature (°F)
1,000~3,000	194	194
3,000~4,000	185	185
4,000~6,000	176	176

Filter Life Reminder and Replacement Guide

A. Filter Life Reminder

WD-MIRF filter: Multiple Reverse Osmosis Membrane Filter

Service life: ≤ 12 months



NOTE: Filter life may vary based on source water quality and water usage. Please replace the filter according to the reminder of the filter life indicator light. Be sure to reset the filter every time after you replace your filter.

Status	Remaining time (day)	Remaining capacity (G)	Indication		Filter status
			Light	Status	
Normal	>15	>40	N/A	N/A	Good
Pre-warning	≤15	≤40	Flash	Beeps 3 times when dispensing water	Replace soon
Warning	≤0	≤0	Light on	Beeps 3 times when dispensing water	Replace now

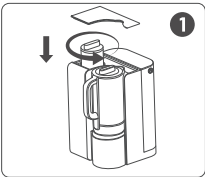
B. Filter Replacement Guide

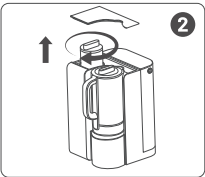

1. Turn counterclockwise and pull out to remove the old filter.



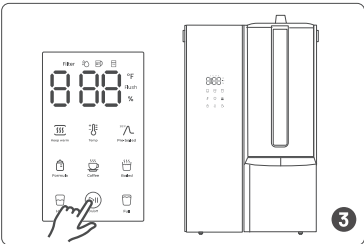

2. Remove the filter package and rotate the new filter clockwise and push downwards to the lock.





3. Hold the “” key for 5 seconds for filter reset.
4. Follow the screen display for flushing operation.

Error Display

Error Display	Issue	Recovery Method
	Timeout protection	Re-power on to restore it. We recommend you call the service hotline or send an email to us.
	Temperature sensor abnormal	Re-power on to restore it. We recommend you call the service hotline or send an email to us.
	Main control panel abnormal	We recommend you call the service hotline or send an email to us.

! NOTE: If you cannot solve the problems by operations, kindly call the service hotline +1-888-352-3558 (U.S.) or send an email to service@waterdropfilter.com for help. Please do not disassemble or attempt to repair the dispenser by yourself to prevent further damage or harm.

Troubleshooting

Issues	Possible Causes
The “  ”key turns red.	Please check if the TDS value of tap water >500.
	Please check if the dispenser was unused for a long time.
	Please check if the filter has expired.
	Please check if the filter has been flushed after filter replacement.
The dispenser fails to produce purified water.	Please check if the power cord is plugged in.
	Please check if the water tank is installed properly.
	Please check if the filter is installed correctly.
	Please check if the feed water tank is at the MIN line.
	Please check if the filter has expired.
The filtered water tastes bad.	Please check if there are any error prompts displayed.
	Please check if the filter of your dispenser has been thoroughly flushed.
	Please check if the filter has been flushed thoroughly after being replaced. If not, please follow the steps in the Instruction Manual to flush the new filter.
	Please check if the dispenser has been unused for a long time. If yes, Please press “  ”key for 5s to flush the system.
There is a deviation between the actual water output and the set water output.	Please check if the feed water tank press onto the power cord.
	There will be deviation in components such as pumps in the dispenser, and the deviation of -10% to 10% is normal.

Dispenser Maintenance

- If you have not used the dispenser for a minimum of 2 days, it is suggested that you discard the remaining water in the tank.
- During the daily water change, it is recommended to clean the feed water tank manually (Once a week is highly recommended) and clean the floating ball, and filter screen in the feed water tank to avoid limescale.
- Use a descaling agent (such as citric acid) to soak the feed water tank for 30 minutes every month and then clean it. Do not use organic solvents such as alcohol to wipe it.
- Clean the drip tray regularly (once a week is recommended) to avoid bacteria and residual water overflow.
- Replace the filter regularly according to the filter life indicator light.
- Do not use steel wool, an abrasive cleaner, or a corrosive liquid such as gasoline or acetone.

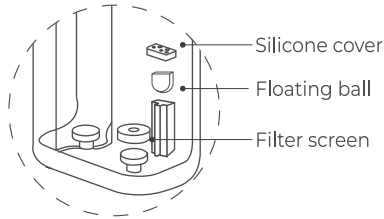

Limited Product Warranty

This product comes with a one-year warranty. The warranty of our product covers defects in materials and workmanship from the original date of purchase. During the warranty period, we will replace or repair any part which is deemed to be defective, if the product has not been subjected to tampering, alteration, lack of regular maintenance or improper use after delivery. The cost of repair or replacement under those excluded circumstances shall be borne by the consumer. This limited warranty does not cover the following items: filter and all other parts or components that require regular replacement as a result of ordinary usage. This limited warranty only applies if the dispenser is installed, used, and maintained in compliance with all instructions and requirements enclosed with the dispenser.

This limited warranty shall only be valid if:

- Working conditions are 5-38°C/41-100°F.
- The feed water must have a pH between 6.5 and 8.5.
- Turbidity must be less than 1.0 NTU.
- The TDS of feed water must be less than 500 ppm.

Any information or suggestion with respect to our product concerning applications, specifications or standards is provided solely for your convenience.

The quality of water supplies may vary seasonably or over a period of time. Your water usage may vary as well. The manufacturer shall assume no liability for the determination of the proper equipment necessary to meet your requirements, and we do not authorize others to assume such obligation on our behalf. You must verify and test the suitability of any information with respect to the product for your specific application.

This limited warranty shall be void if:

- The filter are not replaced on the recommended maintenance schedule.
- The product is purchased from someone other than our official website or our authorized dealers, as we cannot verify or guarantee the integrity or authenticity of the product.

Our sole obligation under this warranty shall be repair or replacement of a non-conforming product or parts of this product, or at our option, return of the product and a refund of the purchase price. Our obligation does not include the cost of transportation. We are not responsible for damage in transit, and claim that such damage should be presented to the carrier by the customer.

! NOTE: In case some states do not allow limitations on how long an implied warranty lasts, you may choose to return the dispenser. If you choose to keep it, you agree that the above limitations still apply to you.

The warranties set forth herein are the only warranties made by us with respect to the product. We make no warranties, expressed or implied, including, but not limited to, any warranties of fitness or merchantability, except as expressly set forth above.



This device complies with part 15 of the FCC Rules. Operation is subject to the following two conditions: (1) This device may not cause harmful interference, and (2) this device must accept any interference received, including interference that may cause undesired operation. Any changes or modifications not expressly approved by the party responsible for compliance could void the user's authority to operate the equipment.

Safety Notice

When using electrical appliances, basic safety precautions should always be followed, including the following:

1. Read all Instructions and save these instructions.
2. Do not touch hot surfaces of glass pure pitcher.
3. Don't remove the pitch when the system is working.
4. To protect against fire, electric shock and injury to persons do not immerse cord, plugs, or in water or other liquid.
5. Close supervision is necessary when any appliance is used by or near children.
6. Unplug from outlet when not in use and before cleaning. Allow to cool before putting on or taking off parts, and before cleaning the appliance.
7. Do not operate any appliance with a damaged cord or plug or after the appliance malfunctions, or has been damaged in any manner. Return appliance to the nearest authorized service facility for examination, repair or adjustment.
8. The use of accessory attachments not recommended by the appliance manufacturer may result in fire, electric shock or injury to persons.
9. Do not use outdoors .
10. Do not let cord hang over edge of table or counter, or touch hot surfaces.
11. Do not place on or near a hot gas or electric burner, or in a heated oven.
12. Always attach plug to appliance first, then plug cord into the wall outlet.
13. Check whether the voltage marked on the system nameplate is consistent with that of the power supply before connecting, so as to avoid damaging components or causing a fire.
14. DO NOT use wet hands to insert/pull the plug or use a damp cloth to clean the plug. These may cause electric shocks.
15. Hold the plug to pull it out when pulling out the plug, and do not pull or twist the power cord to prevent damage and cause leakage danger.
16. Regularly check for damages to the power supply and power cords to avoid major accidents caused by leakage.
17. Always place the dispenser in a ventilated, moisture-proof, sun-proof, and freeze-proof room. Avoid contact with corrosive substances.
18. DO NOT store flammable items such as rags, paper or aerosol cans near the dispenser to reduce the chances of fire incidents. DO NOT store or use gasoline or other flammable vapors and liquids in the vicinity of this or any other appliance.
19. Do not use appliance for other than intended use.

GROUNDING INSTRUCTIONS - This appliance must be grounded. In the event of a malfunction or breakdown, grounding will reduce the risk of electric shock by providing a path of least resistance for electric current.

This appliance is equipped with a cord having an appliance-grounding conductor and a grounding plug.

The plug must be plugged into an appropriate outlet that is installed and grounded in accordance with all local codes and ordinances.

WARNING

Improper connection of the appliance-grounding conductor can result in a risk of electric shock. Check with a qualified electrician or service representative if you are in doubt whether the appliance is properly grounded.

Do not modify the plug provided with the appliance; if it will not fit the outlet, have a proper outlet installed by a qualified technician.

Waterdrop

Filter Better Live Healthier

Please read the manual carefully before using the product.

Manufacturer: Qingdao Ecopure Filter Co., Ltd.

Tel: 1-888-352-3558 (U.S.)

E-mail: service@waterdropfilter.com

Add.: No.13, Yishengbai Road, Jimo, Qingdao, China

V001